



Byrdwell Conference

Cedarmore Main Campus



Renovated in 2010, the Byrdwell Conference Center now boasts a large meeting space along with conference rooms. The large meeting space includes a theatre-style stage, widescreen front displays, sound and lighting. It is an ideal venue for groups up to 200 people.

MEETING

- Maximum seating capacity: 250
- Minimum 150 guests to rent
- Stage, lighting and rear projection screens are provided.
- Seven breakout spaces

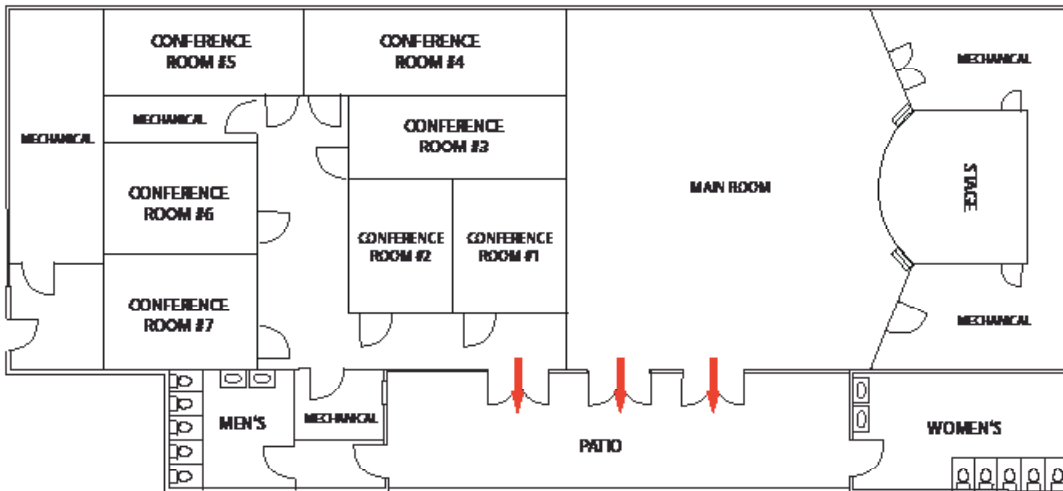

Exterior View



Large Group Space



Small Group Space

Please Select a Set Up Option

Lecture with Isle

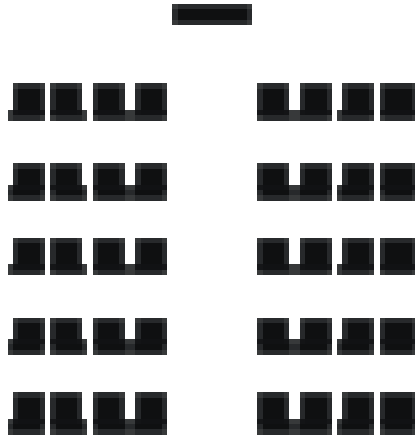

Lecture with Tables

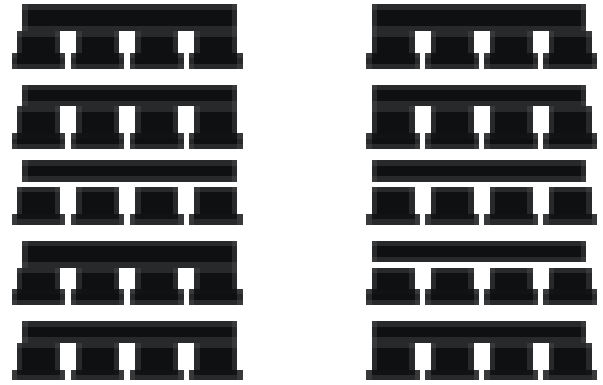

Horseshoe



Boardroom

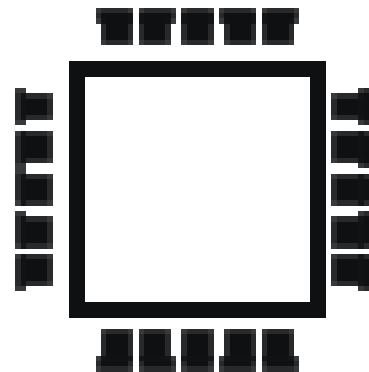

Horseshoe option is only available for groups of 25 or less.